

Stone/scrap handling grab



SK05, SK10, SK15,
SK20, SK30

Adaptable to all excavators in
the weight class 3–32 tonnes

- Cutting implement reinforced with high-tensile steel.
- All engcon SK grabs can be optionally fitted with detachable teeth.
- Load holding valve and pressure accumulator have long-lasting gripping force and ensure safe lifting (SK).
- Complies with European safety standards.
- Expansion buses in large joints.
- Swedish design for outstanding geometry and problem-free operation.



SK20



SK20 with
S70 hitch



SK20 with rotator

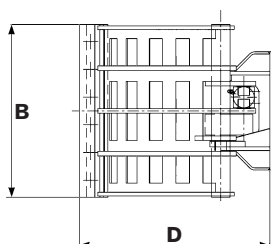
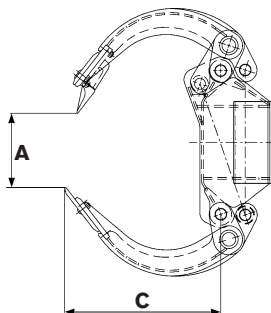

Specifications, stone and scrap handling grab

| Type: | SK05 | SK10 | SK15 | SK20 | SK30 |
|--------------------------------------|------|------|-------|-------|-------|
| Grab width A : (max. mm) | 1110 | 1660 | 1790 | 1990 | 2570 |
| Grab width A : (min. mm) | 0 | 0 | 0 | 0 | 0 |
| Cutting width B : (mm) | 505 | 715 | 860 | 860 | 1170 |
| Jaw length C : (mm) | 460 | 680 | 790 | 870 | 1080 |
| Height D : (mm) | 580 | 790 | 960 | 1070 | 1360 |
| Grab force (kN) | 8,7 | 15 | 19 | 25 | 45 |
| Pressure: (MPa) | 21 | 21 | 21 | 21 | 21 |
| Weight: (kg) | 180 | 325 | 540 | 620 | 1195 |
| Recommended machine weight: (tonnes) | 3–6 | 6–12 | 12–16 | 16–22 | 22–32 |
| Recommended tiltrotator/rotator: | EC05 | EC10 | EC15 | EC20 | EC30 |

Delivered with or without upper hitch and/or tiltrotator/rotator, depending on customer requirements.
engcon reserves the right to modify designs without prior notice.